

## Adjustable Flat Tension Levers • with screw

EH 24441.



### Product Description

Adjustable flat tension levers are used when the swivel range is limited or a specific lever position is required.

Adjustable flat tension levers are characterised by their low construction height and are particularly suitable for use in restricted spaces or when the lever should not overhang..

### Material

#### Lever

- Zinc die-cast, plastic coated, black, similar to RAL 9005, matt structure
- Zinc die-cast, plastic coated, silver, similar to RAL 9006, matt structure

#### Inner parts

- Steel, blackened

#### Screw

- Steel, blackened

#### Covering

- Plastic, black
- Plastic, light grey

### Operation

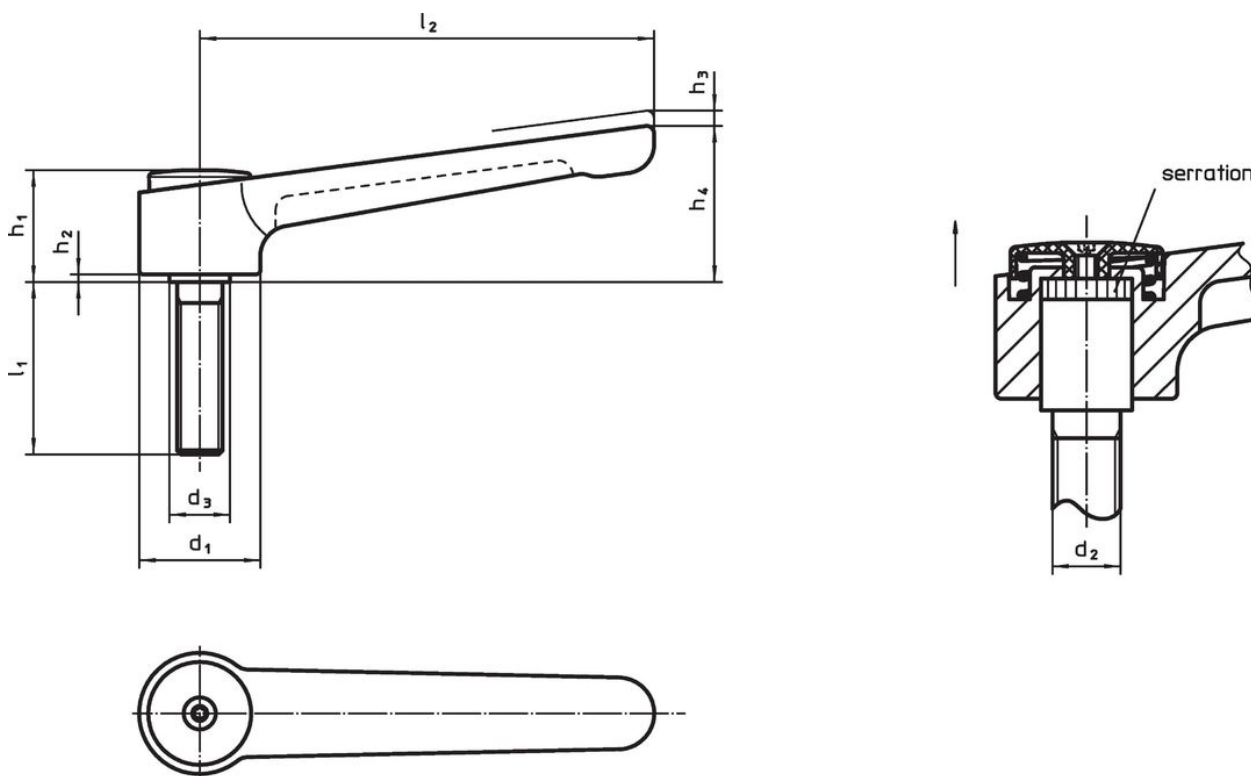

By lifting the lever the serrations are disengaged. The lever can be positioned by the serrations. On releasing the lever, the serrations are automatically re-engaged.

### Drawing



### Order information

Dimensions													Art. No.
d <sub>1</sub>	d <sub>2</sub>	l <sub>1</sub>	d <sub>3</sub>	h <sub>1</sub>	h <sub>2</sub>	h <sub>3</sub>	h <sub>4</sub>	l <sub>2</sub>	min.	max.	[g]		
[mm]									[°C]				
black													
32	M10	20	16	29.5	2	2.5	41.5	120	-30	80	209	24441.0450	
32	M10	25	16	29.5	2	2.5	41.5	120	-30	80	208	24441.0455	
32	M10	32	16	29.5	2	2.5	41.5	120	-30	80	207	24441.0460	
32	M10	40	16	29.5	2	2.5	41.5	120	-30	80	210	24441.0465	
32	M10	50	16	29.5	2	2.5	41.5	120	-30	80	220	24441.0470	

Dimensions									 min.   max. [°C]		 [g]	Art. No.
d <sub>1</sub>	d <sub>2</sub>	l <sub>1</sub>	d <sub>3</sub>	h <sub>1</sub> [mm]	h <sub>2</sub>	h <sub>3</sub>	h <sub>4</sub>	l <sub>2</sub>				
32	M10	63	16	29.5	2	2.5	41.5	120	-30	80	226	<a href="#">24441.0475</a>
32	M10	80	16	29.5	2	2.5	41.5	120	-30	80	231	<a href="#">24441.0480</a>
32	M12	20	16	29.5	2	2.5	41.5	120	-30	80	207	<a href="#">24441.0485</a>
32	M12	25	16	29.5	2	2.5	41.5	120	-30	80	211	<a href="#">24441.0490</a>
32	M12	32	16	29.5	2	2.5	41.5	120	-30	80	215	<a href="#">24441.0495</a>
32	M12	40	16	29.5	2	2.5	41.5	120	-30	80	220	<a href="#">24441.0500</a>
32	M12	50	16	29.5	2	2.5	41.5	120	-30	80	228	<a href="#">24441.0505</a>
32	M12	63	16	29.5	2	2.5	41.5	120	-30	80	238	<a href="#">24441.0510</a>
32	M12	80	16	29.5	2	2.5	41.5	120	-30	80	251	<a href="#">24441.0515</a>
40	M12	32	23	42.0	4	4.0	56.0	145	-30	80	440	<a href="#">24441.0525</a>
40	M12	40	23	42.0	4	4.0	56.0	145	-30	80	446	<a href="#">24441.0530</a>
40	M12	50	23	42.0	4	4.0	56.0	145	-30	80	450	<a href="#">24441.0535</a>
40	M12	63	23	42.0	4	4.0	56.0	145	-30	80	461	<a href="#">24441.0540</a>
40	M12	80	23	42.0	4	4.0	56.0	145	-30	80	477	<a href="#">24441.0545</a>
40	M16	32	23	42.0	4	4.0	56.0	145	-30	80	461	<a href="#">24441.0550</a>
40	M16	40	23	42.0	4	4.0	56.0	145	-30	80	472	<a href="#">24441.0555</a>
40	M16	50	23	42.0	4	4.0	56.0	145	-30	80	482	<a href="#">24441.0560</a>
40	M16	63	23	42.0	4	4.0	56.0	145	-30	80	498	<a href="#">24441.0565</a>
40	M16	80	23	42.0	4	4.0	56.0	145	-30	80	523	<a href="#">24441.0570</a>
silver												
32	M10	20	16	29.5	2	2.5	41.5	120	-30	80	209	<a href="#">24441.0850</a>
32	M10	25	16	29.5	2	2.5	41.5	120	-30	80	208	<a href="#">24441.0855</a>
32	M10	32	16	29.5	2	2.5	41.5	120	-30	80	207	<a href="#">24441.0860</a>
32	M10	40	16	29.5	2	2.5	41.5	120	-30	80	210	<a href="#">24441.0865</a>
32	M10	50	16	29.5	2	2.5	41.5	120	-30	80	220	<a href="#">24441.0870</a>
32	M10	63	16	29.5	2	2.5	41.5	120	-30	80	226	<a href="#">24441.0875</a>
32	M10	80	16	29.5	2	2.5	41.5	120	-30	80	231	<a href="#">24441.0880</a>
32	M12	20	16	29.5	2	2.5	41.5	120	-30	80	207	<a href="#">24441.0885</a>
32	M12	25	16	29.5	2	2.5	41.5	120	-30	80	211	<a href="#">24441.0890</a>
32	M12	32	16	29.5	2	2.5	41.5	120	-30	80	215	<a href="#">24441.0895</a>
32	M12	40	16	29.5	2	2.5	41.5	120	-30	80	220	<a href="#">24441.0900</a>
32	M12	50	16	29.5	2	2.5	41.5	120	-30	80	228	<a href="#">24441.0905</a>
32	M12	63	16	29.5	2	2.5	41.5	120	-30	80	238	<a href="#">24441.0910</a>
32	M12	80	16	29.5	2	2.5	41.5	120	-30	80	251	<a href="#">24441.0915</a>
40	M12	32	23	42.0	4	4.0	56.0	145	-30	80	440	<a href="#">24441.0925</a>
40	M12	40	23	42.0	4	4.0	56.0	145	-30	80	446	<a href="#">24441.0930</a>
40	M12	50	23	42.0	4	4.0	56.0	145	-30	80	450	<a href="#">24441.0935</a>
40	M12	63	23	42.0	4	4.0	56.0	145	-30	80	461	<a href="#">24441.0940</a>
40	M12	80	23	42.0	4	4.0	56.0	145	-30	80	477	<a href="#">24441.0945</a>
40	M16	32	23	42.0	4	4.0	56.0	145	-30	80	461	<a href="#">24441.0950</a>
40	M16	40	23	42.0	4	4.0	56.0	145	-30	80	472	<a href="#">24441.0955</a>
40	M16	50	23	42.0	4	4.0	56.0	145	-30	80	482	<a href="#">24441.0960</a>
40	M16	63	23	42.0	4	4.0	56.0	145	-30	80	498	<a href="#">24441.0965</a>
40	M16	80	23	42.0	4	4.0	56.0	145	-30	80	523	<a href="#">24441.0970</a>

### Application example

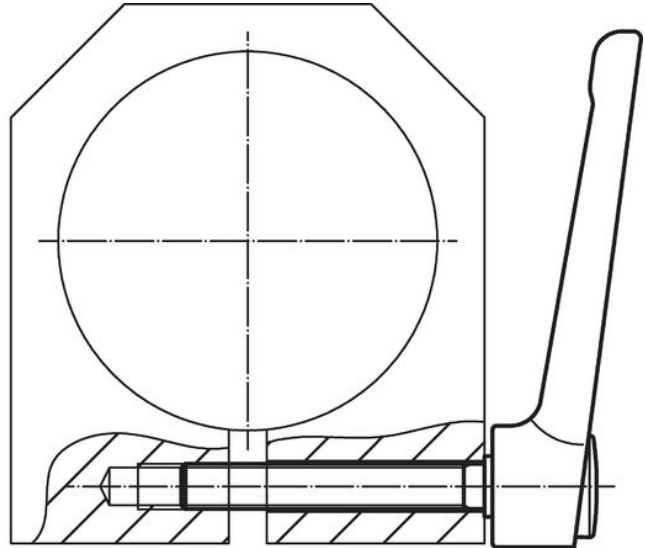
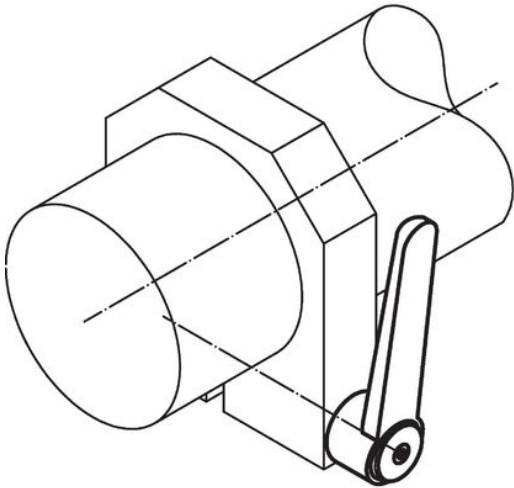

### Compliance

#### RoHS compliant

Contains lead - compliant according to exceptions 6a / 6b / 6c.

#### Contains SVHC substances >0,1% w/w

Contains lead - SVHC list [REACH] as of 27.06.2024.

#### Contains Proposition 65 substances



Lead can cause cancer and reproductive harm from exposure  
<https://www.P65Warnings.ca.gov/>

#### Free from Conflict Minerals

This product does not contain any substances designated as "conflict minerals" such as tantalum, tin, gold or tungsten from the Democratic Republic of Congo or adjacent countries.