

Star Grips • DIN 6336 light metal

24660.0680



Product Description

These star grips are manufactured according to DIN 6336.

Material

Handle

- Light metal Al, polished

Drawing

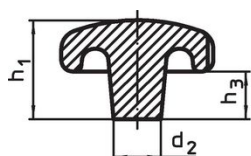

picture 1

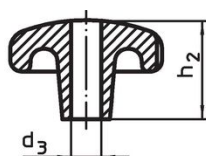

picture 2

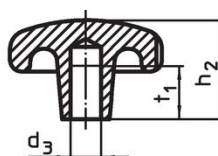

picture 3

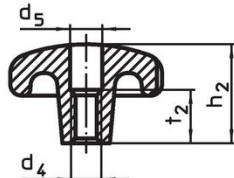
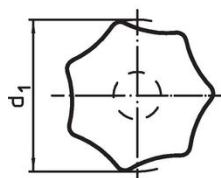

picture 4

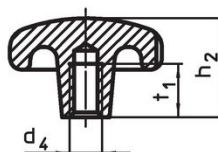

picture 5

Order information

| d ₁ | d ₂ | Dimensions | | | [g] | Art. No. |
|--|----------------|------------------------------|----------------|------------------------|-----|------------|
| | | d ₃ H7 [mm] | h ₂ | t ₁ min. | | |
| with smooth blind hole, form C – picture 3, polished | | | | | | |
| 80 | 25 | 16 | 50 | 28 | 223 | 24660.0680 |

Compliance

RoHS compliant

Contains lead - compliant according to exceptions 6a / 6b / 6c.

Contains SVHC substances >0,1% w/w

Contains lead - SVHC list [REACH] as of 27.06.2024.

Contains Proposition 65 substances



Lead can cause cancer and reproductive harm from exposure
<https://www.P65Warnings.ca.gov/>

Free from Conflict Minerals

This product does not contain any substances designated as "conflict minerals" such as tantalum, tin, gold or tungsten from the Democratic Republic of Congo or adjacent countries.