

Wedge Elements · coated

1703.360



Product Description

Body:

- Wedge elements for pre-machined, surface conditions and materials
- Quick to exchange
- Minimum clamping depth 8 mm
- Please order the pads separately

Pad:

- For secure clamping of workpieces without causing deformation to the clamped surfaces
- Scope of delivery 20 pcs

Material

- Steel, hardened

Drawing

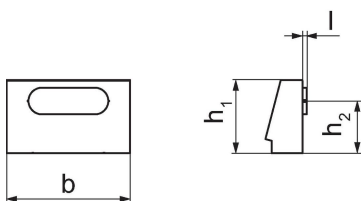

Order information

b	l	Dimensions		[g]	Art. No.
		h ₁ [mm]	h ₂		
27.8	1	16.5	11.75	17	1703.360

Accessories

	[g]	Art. No.
Pad		
	26	1703.370

Compliance

RoHS compliant

Compliant according to Directive 2011/65/EU and Directive 2015/863.

Does not contain SVHC substances

No SVHC substances with more than 0.1% w/w contained - SVHC list [REACH] as of 23.01.2024.

Does not contain Proposition 65 substances

No Proposition 65 substances included.
<https://www.P65Warnings.ca.gov/>

Free from Conflict Minerals

This product does not contain any substances designated as "conflict minerals" such as tantalum, tin, gold or tungsten from the Democratic Republic of Congo or adjacent countries.