

Star Grips • DIN 6336 light metal  
EH 24660.



**Product Description**

These star grips are manufactured according to DIN 6336.

**Material**

**Handle**

- Light metal Al, unpolished
- Light metal Al, polished

**Drawing**

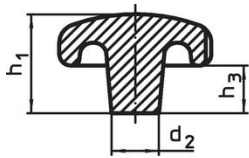

picture 1

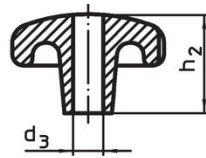

picture 2

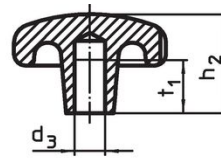

picture 3

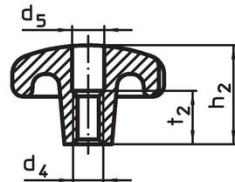
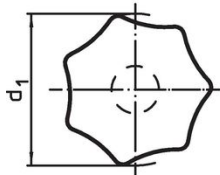

picture 4

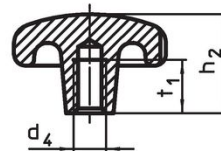

picture 5

**Order information**

| Dimensions  |                |                      |                |                |                |                |                |                        |                |     | Art. No.                   |
|---|----------------|----------------------|----------------|----------------|----------------|----------------|----------------|------------------------|----------------|-----|----------------------------|
| d <sub>1</sub>  | d <sub>2</sub> | d <sub>3</sub><br>H7 | d <sub>4</sub> | d <sub>5</sub> | h <sub>1</sub> | h <sub>2</sub> | h <sub>3</sub> | t <sub>1</sub><br>min. | t <sub>2</sub> | [g] |                            |
| <b>raw part, form A – picture 1, unpolished</b>                 |                |                      |                |                |                |                |                |                        |                |     |                            |
| 40  | 14             | –                    | –              | –              | 26             | –              | 13             | –                      | –              | 36  | <a href="#">24660.0040</a> |
| 50  | 18             | –                    | –              | –              | 34             | –              | 17             | –                      | –              | 70  | <a href="#">24660.0050</a> |
| 63  | 20             | –                    | –              | –              | 42             | –              | 21             | –                      | –              | 128 | <a href="#">24660.0063</a> |
| 80  | 25             | –                    | –              | –              | 52             | –              | 25             | –                      | –              | 245 | <a href="#">24660.0080</a> |
| <b>with smooth blind hole, form C – picture 3, unpolished</b>   |                |                      |                |                |                |                |                |                        |                |     |                            |
| 40  | 14             | 8                    | –              | –              | –              | 25             | –              | 15                     | –              | 30  | <a href="#">24660.0240</a> |
| 50  | 18             | 10                   | –              | –              | –              | 32             | –              | 18                     | –              | 63  | <a href="#">24660.0250</a> |
| 63  | 20             | 12                   | –              | –              | –              | 40             | –              | 22                     | –              | 117 | <a href="#">24660.0263</a> |
| 80  | 25             | 16                   | –              | –              | –              | 50             | –              | 28                     | –              | 223 | <a href="#">24660.0280</a> |
| <b>with thread, drilled out, form D – picture 4, unpolished</b> |                |                      |                |                |                |                |                |                        |                |     |                            |
| 40  | 14             | –                    | M 8            | 8.4            | –              | 25             | –              | –                      | 13             | 32  | <a href="#">24660.0340</a> |
| 50  | 18             | –                    | M10            | 10.5           | –              | 32             | –              | –                      | 16             | 62  | <a href="#">24660.0350</a> |
| 63  | 20             | –                    | M12            | 13.0           | –              | 40             | –              | –                      | 20             | 109 | <a href="#">24660.0363</a> |
| 80  | 25             | –                    | M16            | 17.0           | –              | 50             | –              | –                      | 20             | 218 | <a href="#">24660.0380</a> |
| <b>with threaded blind hole, form E – picture 5, unpolished</b> |                |                      |                |                |                |                |                |                        |                |     |                            |
| 40  | 14             | –                    | M 8            | –              | –              | 25             | –              | 15                     | –              | 33  | <a href="#">24660.0440</a> |
| 50  | 18             | –                    | M10            | –              | –              | 32             | –              | 18                     | –              | 63  | <a href="#">24660.0450</a> |
| 63  | 20             | –                    | M12            | –              | –              | 40             | –              | 22                     | –              | 118 | <a href="#">24660.0463</a> |
| 80  | 25             | –                    | M16            | –              | –              | 50             | –              | 28                     | –              | 227 | <a href="#">24660.0480</a> |

| d <sub>1</sub>  | d <sub>2</sub> | d <sub>3</sub><br>H7 | d <sub>4</sub> | Dimensions             |                |                |                |                        |                | [g] | Art. No.   |
|---|----------------|----------------------|----------------|------------------------|----------------|----------------|----------------|------------------------|----------------|-----|------------|
|   |                |                      |                | d <sub>5</sub><br>[mm] | h <sub>1</sub> | h <sub>2</sub> | h <sub>3</sub> | t <sub>1</sub><br>min. | t <sub>2</sub> |     |            |
| <b>with smooth blind hole, form C – picture 3, polished</b>   |                |                      |                |                        |                |                |                |                        |                |     |            |
| 40  | 14             | 8                    | –              | –                      | –              | 25             | –              | 15                     | –              | 30  | 24660.0640 |
| 50  | 18             | 10                   | –              | –                      | –              | 32             | –              | 18                     | –              | 63  | 24660.0650 |
| 63  | 20             | 12                   | –              | –                      | –              | 40             | –              | 22                     | –              | 117 | 24660.0663 |
| 80  | 25             | 16                   | –              | –                      | –              | 50             | –              | 28                     | –              | 223 | 24660.0680 |
| <b>with thread, drilled out, form D – picture 4, polished</b> |                |                      |                |                        |                |                |                |                        |                |     |            |
| 40  | 14             | –                    | M 8            | 8.4                    | –              | 25             | –              | –                      | 13             | 32  | 24660.0740 |
| 50  | 18             | –                    | M10            | 10.5                   | –              | 32             | –              | –                      | 16             | 62  | 24660.0750 |
| 63  | 20             | –                    | M12            | 13.0                   | –              | 40             | –              | –                      | 20             | 109 | 24660.0763 |
| 80  | 25             | –                    | M16            | 17.0                   | –              | 50             | –              | –                      | 20             | 218 | 24660.0780 |
| <b>with threaded blind hole, form E – picture 5, polished</b> |                |                      |                |                        |                |                |                |                        |                |     |            |
| 40  | 14             | –                    | M 8            | –                      | –              | 25             | –              | 15                     | –              | 33  | 24660.0840 |
| 50  | 18             | –                    | M10            | –                      | –              | 32             | –              | 18                     | –              | 63  | 24660.0850 |
| 63  | 20             | –                    | M12            | –                      | –              | 40             | –              | 22                     | –              | 118 | 24660.0863 |
| 80  | 25             | –                    | M16            | –                      | –              | 50             | –              | 28                     | –              | 227 | 24660.0880 |

## Compliance

### RoHS compliant

Contains lead - compliant according to exceptions 6a / 6b / 6c.

### Contains SVHC substances >0,1% w/w

Contains lead - SVHC list [REACH] as of 23.01.2024.

### Contains Proposition 65 substances



Lead can cause cancer and reproductive harm from exposure  
<https://www.P65Warnings.ca.gov/>

### Free from Conflict Minerals

This product does not contain any substances designated as "conflict minerals" such as tantalum, tin, gold or tungsten from the Democratic Republic of Congo or adjacent countries.