

## Clamping Devices Actima

EH 23260.



### Product Description

The compact clamping element can be converted between pull and push clamping strain, depending on the model. The travel path is 10 mm. Within the short clamp travel of 2 mm, self-locking occurs in any position. The maximum permitted clamping force is 4.9 kN.

### Material

#### Housing

- Thermoplastic, black

#### Body

- Steel, blackened

#### Ball knob

- Thermosetting plastic PF 31, red similar to RAL 3003

#### Accessories

- Steel, blackened

Drawing

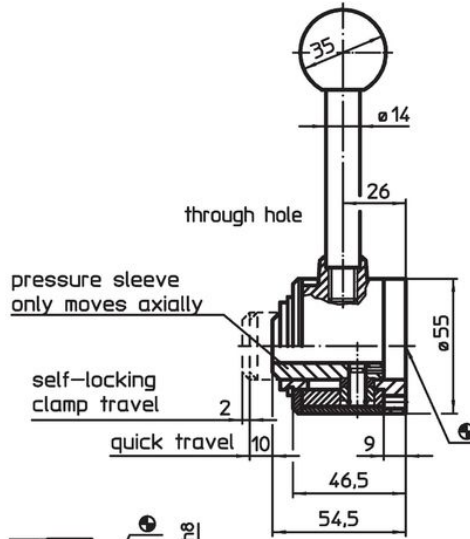
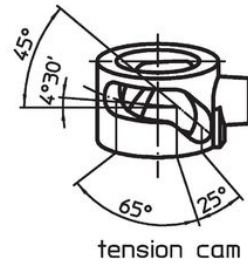
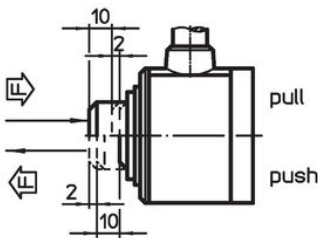
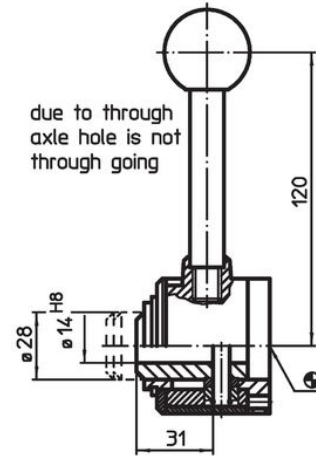
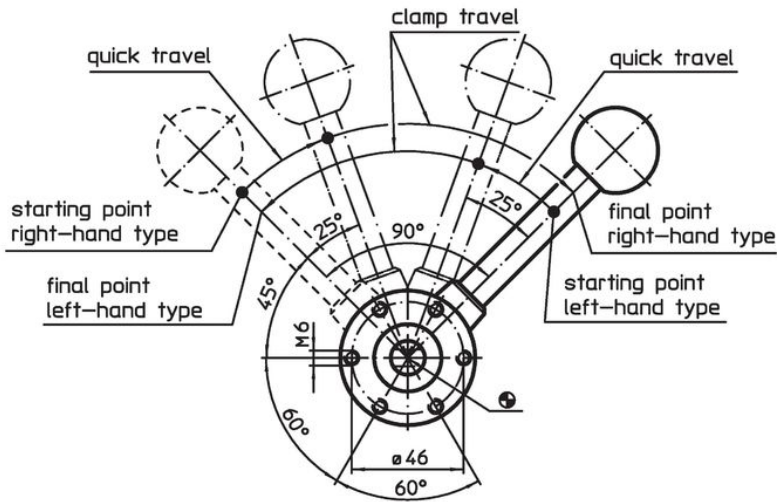



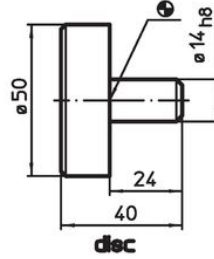
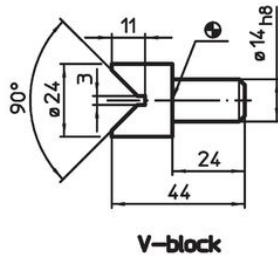
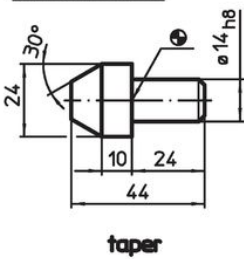

accessories



Order information

Travel path [mm]	s Clamping way [mm]	Clamping force max. [kN]	 [g]	Art. No.
<b>pull to right, with transverse axis in the bore</b>				
10	2	4.9	751	23260.0003
<b>pull to left, with transverse axis in the bore</b>				
10	2	4.9	749	23260.0005
<b>pull to right, with throughgoing bore</b>				
10	2	4.9	751	23260.0013
<b>pull to left, with throughgoing bore</b>				
10	2	4.9	749	23260.0015
<b>push to right, with transverse axis in the bore</b>				
10	2	4.9	751	23260.0002
<b>push to left, with transverse axis in the bore</b>				
10	2	4.9	749	23260.0004
<b>push to right, with throughgoing bore</b>				
10	2	4.9	751	23260.0012
<b>push to left, with throughgoing bore</b>				
10	2	4.9	749	23260.0014

Accessories

	 [g]	Art. No.
<b>Disc</b>		
	270	23260.0042
<b>taper</b>		
	85	23260.0044
<b>V-block</b>		
	82	23260.0046

Application example

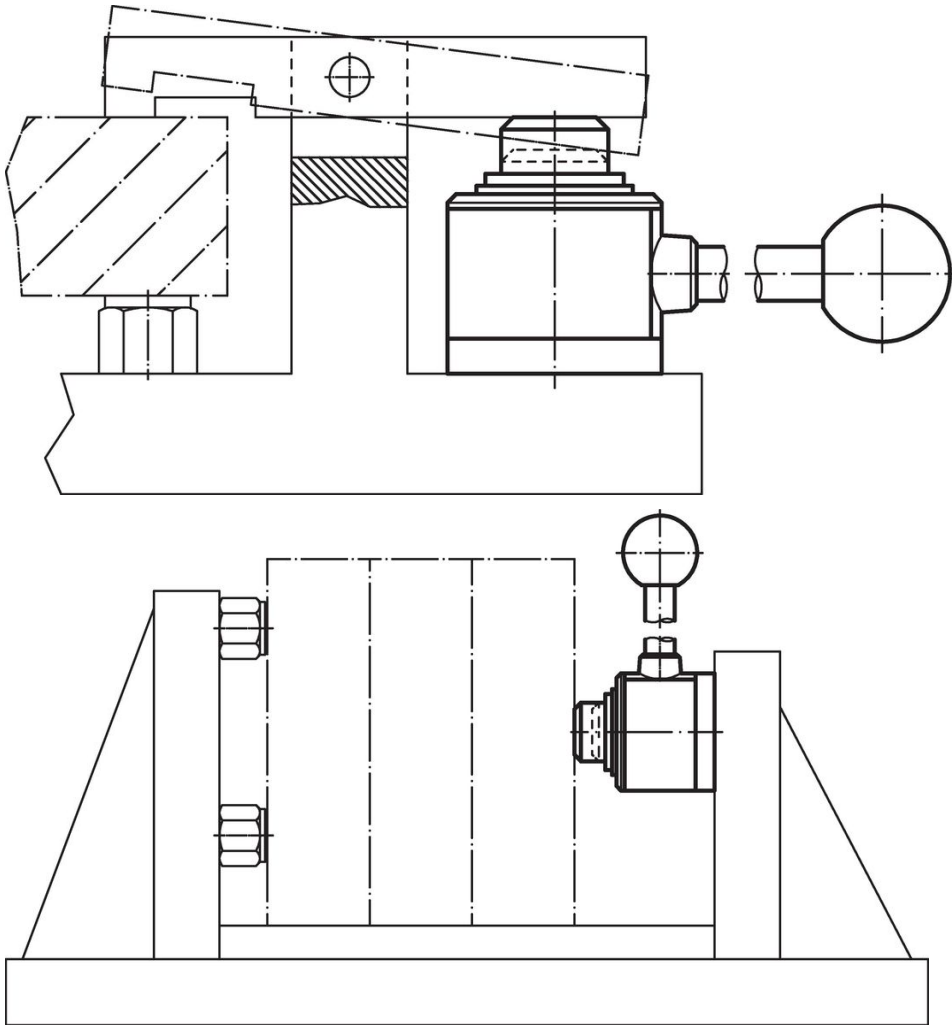

Compliance

For detailed compliance information please select the desired article number.