

## Ball Casters • screwable, plain bearing

EH 22752.



### Product Description

For positioning and aligning of workpieces. Because of the slide bearing, the ball can roll permanently, and the surface of the workpiece is protected.

At temperatures > 20°C, the carrying figure decreases linearly. (Example: at 90°C the load bearing capacity is max. 60%)

### Material

**Bearing**  
• plastic

**Ball**  
• Ball-bearing steel, hardened  
• Stainless steel, hardened

**Screw**  
• Free cutting steel, blackened  
• Stainless steel 1.4305

### More information

### Notes

Customized design on request.

### Drawing

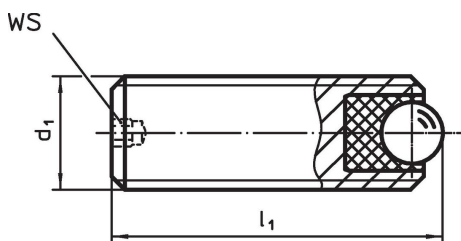

### Order information

d <sub>1</sub>	Dimensions		WS [mm]	Static carrying figure C <sub>0</sub> [N]	Tightening torque max. [Nm]	Temperature		Weight [g]	Art. No.
	l <sub>1</sub>	Ball diameter				min.	max.		
		[mm]			[°C]				
<b>Free cutting steel</b>									
M 6	8	2.5	1.5	172	0.11	-50	90	1.0	<a href="#">22752.0061</a>
M 6	16	2.5	1.5	172	0.11	-50	90	2.4	<a href="#">22752.0064</a>
M 8	10	3.5	1.5	336	0.28	-50	90	2.4	<a href="#">22752.0081</a>
M 8	20	3.5	1.5	336	0.28	-50	90	5.5	<a href="#">22752.0084</a>
M10	12	4.5	2.0	556	0.58	-50	90	4.2	<a href="#">22752.0101</a>
M10	25	4.5	2.0	556	0.58	-50	90	11.0	<a href="#">22752.0104</a>
M12	16	6.5	2.5	1161	1.44	-50	90	7.7	<a href="#">22752.0121</a>
M12	35	6.5	2.5	1161	1.44	-50	90	21.0	<a href="#">22752.0124</a>
M16	20	8.5	3.0	1986	3.21	-50	90	20.0	<a href="#">22752.0161</a>
M16	50	8.5	3.0	1986	3.21	-50	90	58.0	<a href="#">22752.0166</a>
<b>Stainless steel</b>									
M 6	8	2.5	1.5	172	0.11	-50	90	1.0	<a href="#">22752.0561</a>
M 6	16	2.5	1.5	172	0.11	-50	90	2.4	<a href="#">22752.0564</a>
M 8	10	3.5	1.5	336	0.28	-50	90	2.4	<a href="#">22752.0581</a>
M 8	20	3.5	1.5	336	0.28	-50	90	5.5	<a href="#">22752.0584</a>
M10	12	4.5	2.0	556	0.58	-50	90	4.2	<a href="#">22752.0601</a>
M10	25	4.5	2.0	556	0.58	-50	90	11.0	<a href="#">22752.0604</a>
M12	16	6.5	2.5	1161	1.44	-50	90	7.7	<a href="#">22752.0621</a>
M12	35	6.5	2.5	1161	1.44	-50	90	21.0	<a href="#">22752.0624</a>
M16	20	8.5	3.0	1986	3.21	-50	90	20.0	<a href="#">22752.0661</a>
M16	50	8.5	3.0	1986	3.21	-50	90	58.0	<a href="#">22752.0666</a>

Application example

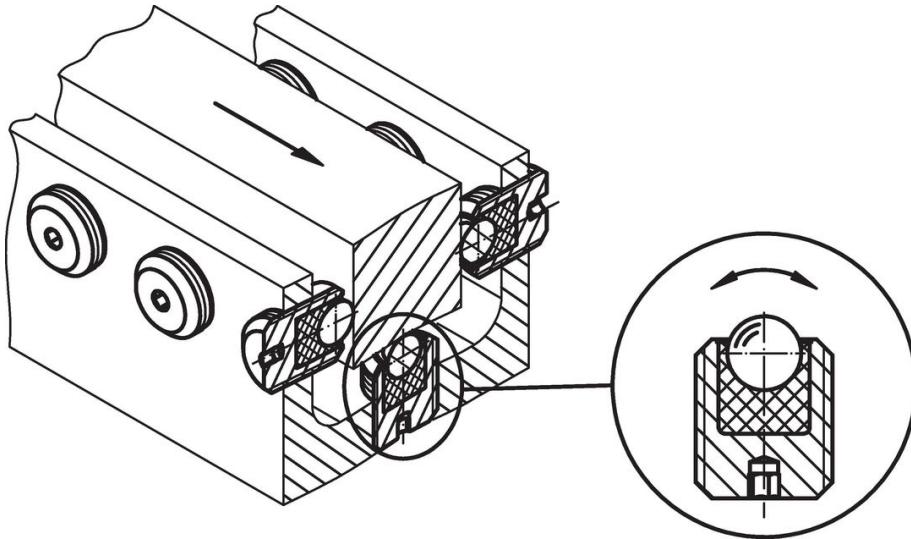

Compliance

For detailed compliance information please select the desired article number.