

Self-Aligning Pads · with hard metal ball, ribbed EH 22730.



Product Description

Especially designed for cast parts (hard casting crust). To be used as support, thrust pad and for build into clamping elements.

Material

Ball

- Hard metal, ribbed, nickel-plated

Body

- Heat-treated steel, tempered, phosphated
- Stainless steel 1.4057, heat-treated

More information

Notes

Ball protected against rotating.
Loading capacity valid for steel and stainless steel designs.

Drawing

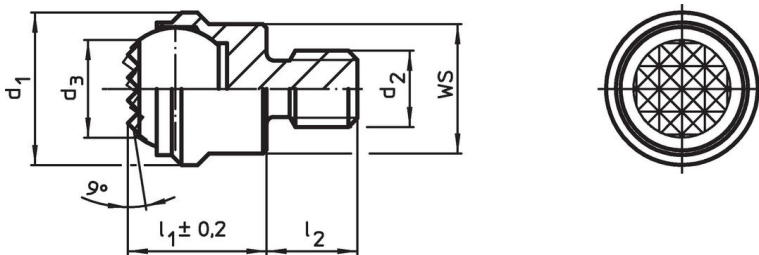

Order information

d ₁	d ₂	Dimensions			Ball diameter	WS	Load capacity for static load max.	Tightening torque max.	g	Art. No.
		d ₃	l ₁ ±0.2	l ₂ -0.5						
with male thread, flat-faced ball, bearing surface ribbed, Heat-treated steel										
13	M 6	8.3	13	8	10	11	10	10	14	22730.0362
13	M 8	8.3	13	8	10	11	10	25	15	22730.0363
20	M 8	13.2	18	10	16	17	25	25	49	22730.0378
20	M10	13.2	18	10	16	17	25	46	50	22730.0379
20	M12	13.2	18	12	16	17	25	82	54	22730.0380
30	M16	20.0	27	16	25	27	90	206	186	22730.0381
50	M20	34.5	35	20	40	41	165	407	633	22730.0382
50	M24	34.5	35	24	40	41	165	698	664	22730.0383
with male thread, flat-faced ball, bearing surface ribbed, Stainless steel										
13	M 6	8.3	13	8	10	11	10	10	14	22730.0390
13	M 8	8.3	13	8	10	11	10	25	15	22730.0392
20	M 8	13.2	18	10	16	17	25	25	49	22730.0394
20	M10	13.2	18	10	16	17	25	46	50	22730.0396
20	M12	13.2	18	12	16	17	25	82	54	22730.0398
30	M16	20.0	27	16	25	27	90	206	186	22730.0399
50	M20	34.5	35	20	40	41	165	407	633	22730.0400
50	M24	34.5	35	24	40	41	165	698	664	22730.0401

Application example

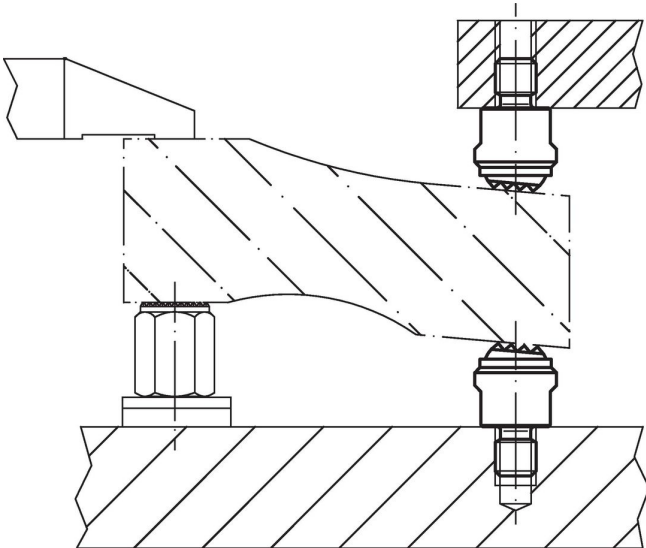

Compliance

RoHS compliant

Compliant according to Directive 2011/65/EU and Directive 2015/863.

Does not contain SVHC substances

No SVHC substances with more than 0.1% w/w contained - SVHC list [REACH] as of 27.06.2024.

Does not contain Proposition 65 substances

No Proposition 65 substances included.

<https://www.P65Warnings.ca.gov/>

Free from Conflict Minerals

This product does not contain any substances designated as "conflict minerals" such as tantalum, tin, gold or tungsten from the Democratic Republic of Congo or adjacent countries.