

Ball-Ended Thrust Screws • headed, flat-faced ball

EH 22710.



Product Description

Ball-ended thrust screws can also be used for clamping, tightening or supporting of non-parallel surfaces.
The flat-faced, movable ball enables a flat load transmission.

Material

Ball

- Ball-bearing steel, hardened
- Stainless steel, hardened

Screw

- Heat-treated steel, $1200 \pm 100 \text{ N/mm}^2$
- Stainless steel 1.4305

More information

Notes

Ball not secured against rotating.
Customized design on request.

References

Thread lock on request, please refer to appendix - Technical Data -

Further products

- Ball-Ended Thrust Screws, headed, ball protected against rotating

Drawing

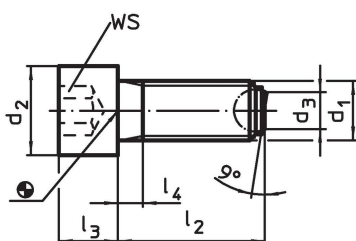

Order information

d ₁	l ₂ ~	d ₂	Dimensions			Ball diameter	WS [mm]	Load capacity for static load ¹⁾ max. [kN]	[g]	Art. No.
			d ₃	l ₃	l ₄					
[mm]										
bearing surface plain, Heat-treated steel										
M 6	20	10	3.2	6	3.0	4.0	5	9	6.1	22710.0562
M 6	30	10	3.2	6	3.0	4.0	5	9	7.8	22710.0564
M 6	40	10	3.2	6	16.0	4.0	5	9	9.9	22710.0566
M 8	20	13	4.5	8	3.5	5.5	6	15	12.0	22710.0582
M 8	35	13	4.5	8	3.5	5.5	6	15	17.0	22710.0584
M 8	50	13	4.5	8	22.0	5.5	6	15	23.0	22710.0586
M10	25	16	6.0	10	4.5	7.0	8	20	24.0	22710.0602
M10	40	16	6.0	10	4.5	7.0	8	20	32.0	22710.0604
M10	60	16	6.0	10	28.0	7.0	8	20	44.0	22710.0606
M12	30	18	7.2	12	5.0	8.5	10	30	38.0	22710.0622
M12	50	18	7.2	12	5.0	8.5	10	30	52.0	22710.0624
M12	80	18	7.2	12	44.0	8.5	10	30	80.0	22710.0626
M16	40	24	10.7	16	6.0	12.0	14	60	95.0	22710.0662
M16	60	24	10.7	16	6.0	12.0	14	60	121.0	22710.0664
M16	80	24	10.7	16	36.0	12.0	14	60	153.0	22710.0666
M20	50	30	13.5	20	7.5	15.0	17	90	185.0	22710.0702
M20	80	30	13.5	20	28.0	15.0	17	90	254.0	22710.0704
M20	100	30	13.5	20	48.0	15.0	17	90	304.0	22710.0706
M24	60	36	15.8	24	9.0	18.0	19	120	323.0	22710.0742
M24	90	36	15.8	24	30.0	18.0	19	120	424.0	22710.0744
M24	120	36	15.8	24	60.0	18.0	19	120	526.0	22710.0746

¹⁾ Statements on load capacity are not valid for the stainless steel type.

d ₁	l ₂ ~	d ₂	Dimensions			Ball diameter	WS [mm]	Load capacity for static load ¹⁾ max. [kN]	 [g]	Art. No.
			d ₃	l ₃	l ₄					
bearing surface plain , Stainless steel										
M 6	20	10	3.2	6	3.0	4.0	5	9	6.1	22710.0832
M 6	30	10	3.2	6	3.0	4.0	5	9	7.8	22710.0834
M 6	40	10	3.2	6	16.0	4.0	5	9	9.9	22710.0836
M 8	20	13	4.5	8	3.5	5.5	6	15	12.0	22710.0842
M 8	35	13	4.5	8	3.5	5.5	6	15	17.0	22710.0844
M 8	50	13	4.5	8	22.0	5.5	6	15	23.0	22710.0846
M10	25	16	6.0	10	4.5	7.0	8	20	24.0	22710.0852
M10	40	16	6.0	10	4.5	7.0	8	20	32.0	22710.0854
M10	60	16	6.0	10	28.0	7.0	8	20	44.0	22710.0856
M12	30	18	7.2	12	5.0	8.5	10	30	38.0	22710.0862
M12	50	18	7.2	12	5.0	8.5	10	30	52.0	22710.0864
M12	80	18	7.2	12	44.0	8.5	10	30	80.0	22710.0866
M16	40	24	10.7	16	6.0	12.0	14	60	95.0	22710.0872
M16	60	24	10.7	16	6.0	12.0	14	60	121.0	22710.0874
M16	80	24	10.7	16	36.0	12.0	14	60	153.0	22710.0876
bearing surface ribbed, Heat-treated steel										
M 8	20	13	4.5	8	3.5	5.5	6	15	12.0	22710.0892
M 8	35	13	4.5	8	3.5	5.5	6	15	17.0	22710.0894
M 8	50	13	4.5	8	22.0	5.5	6	15	23.0	22710.0896
M10	25	16	6.0	10	4.5	7.0	8	20	24.0	22710.0902
M10	40	16	6.0	10	4.5	7.0	8	20	31.0	22710.0904
M10	60	16	6.0	10	28.0	7.0	8	20	44.0	22710.0906
M12	30	18	7.2	12	5.0	8.5	10	30	38.0	22710.0922
M12	50	18	7.2	12	5.0	8.5	10	30	52.0	22710.0924
M12	80	18	7.2	12	44.0	8.5	10	30	80.0	22710.0926
M16	40	24	10.7	16	6.0	12.0	14	60	93.0	22710.0962
M16	60	24	10.7	16	6.0	12.0	14	60	121.0	22710.0964
M16	80	24	10.7	16	36.0	12.0	14	60	152.0	22710.0966
M20	50	30	13.5	20	7.5	15.0	17	90	184.0	22710.0972
M20	80	30	13.5	20	28.0	15.0	17	90	255.0	22710.0974
M20	100	30	13.5	20	48.0	15.0	17	90	303.0	22710.0976
M24	60	36	15.8	24	9.0	18.0	19	120	324.0	22710.0982
M24	90	36	15.8	24	30.0	18.0	19	120	426.0	22710.0984
M24	120	36	15.8	24	60.0	18.0	19	120	528.0	22710.0986

¹⁾ Statements on load capacity are not valid for the stainless steel type.

Compliance

RoHS compliant

Compliant according to Directive 2011/65/EU and Directive 2015/863.

Does not contain SVHC substances

No SVHC substances with more than 0.1% w/w contained - SVHC list [REACH] as of 27.06.2024.

Does not contain Proposition 65 substances

No Proposition 65 substances included.

<https://www.P65Warnings.ca.gov/>

Free from Conflict Minerals

This product does not contain any substances designated as "conflict minerals" such as tantalum, tin, gold or tungsten from the Democratic Republic of Congo or adjacent countries.