

V-Block Elements right/left

EH 1548.700 - EH 1648.800



Product Description

Material

- Steel, case-hardened, ground

Drawing

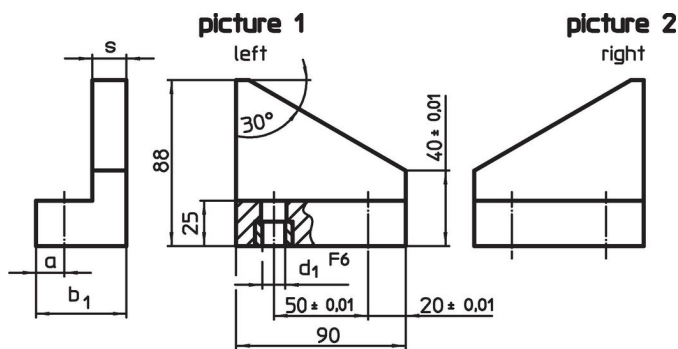

D1 (mm)	n x T (mm)	X
40-330	1x50= 50	190
140-430	2x50=100	240
240-530	3x50=150	290
340-630	4x50=200	340
440-730	5x50=250	390
540-830	6x50=300	440
640-930	7x50=350	490
740-1030	8x50=400	540
840-1130	9x50=450	590

Order information

System	Dimensions				[g]	Art. No.
	b ₁	d ₁	s	a		
right – picture 2						
L12	48	12	18	15	1296	1548.700
L16	53	16	20	17	1437	1648.700
left – picture 1						
L12	48	12	18	15	1308	1548.800
L16	53	16	20	17	1431	1648.800

Compliance

RoHS compliant

Compliant according to Directive 2011/65/EU and Directive 2015/863.

Does not contain SVHC substances

No SVHC substances with more than 0.1% w/w contained - SVHC list [REACH] as of 27.06.2024.

Does not contain Proposition 65 substances

No Proposition 65 substances included.

<https://www.P65Warnings.ca.gov/>

Free from Conflict Minerals

This product does not contain any substances designated as "conflict minerals" such as tantalum, tin, gold or tungsten from the Democratic Republic of Congo or adjacent countries.