

Self-Aligning Pads · with hard metal ball, ribbed

22730.0381



Product Description

Especially designed for cast parts (hard casting crust). To be used as support, thrust pad and for build into clamping elements.

Material

Ball

- Hard metal, ribbed, nickel-plated

Body

- Heat-treated steel, tempered, phosphated

More information

Notes

Ball protected against rotating.
Loading capacity valid for steel and stainless steel designs.

Drawing

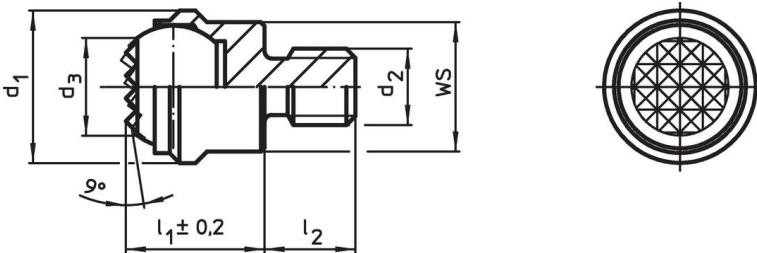

Order information

d ₁	d ₂	d ₃	Dimensions		Ball diameter	WS	Load capacity for static load max.	Tightening torque max.	g	Art. No.
			l ₁ ±0.2	l ₂ -0.5						
with male thread, flat-faced ball, bearing surface ribbed, Heat-treated steel										
30	M16	20	27	16	25	27	90	206	186	22730.0381

Application example



Compliance

RoHS compliant

Compliant according to Directive 2011/65/EU and Directive 2015/863.

Does not contain SVHC substances

No SVHC substances with more than 0.1% w/w contained - SVHC list [REACH] as of 23.01.2024.

Does not contain Proposition 65 substances

No Proposition 65 substances included.

<https://www.P65Warnings.ca.gov/>

Free from Conflict Minerals

This product does not contain any substances designated as "conflict minerals" such as tantalum, tin, gold or tungsten from the Democratic Republic of Congo or adjacent countries.